

PROJECT DATA

CLIENT: COSTCO WHOLESale
999 LAKE DRIVE
ISSAQUAH, WA 98027

PROJECT ADDRESS: 12700 DAY STREET
MORENO VALLEY, CA 92533

ZONING: SP200 MUC

SITE AREA: 12,726 ACRES (553,303 S.F.)

JURISDICTION: CITY OF MORENO VALLEY

SETBACKS: 60'-0" @ NORTH & EAST
TO PROPERTY LINE

BOUNDARIES INFORMATION: THIS PLAN HAS BEEN PREPARED BY NASLAND ALTA/ACSM LAND TITLE SURVEY DATED 07.05.2006

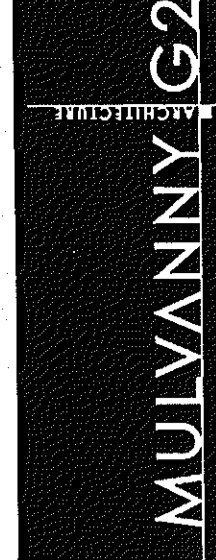
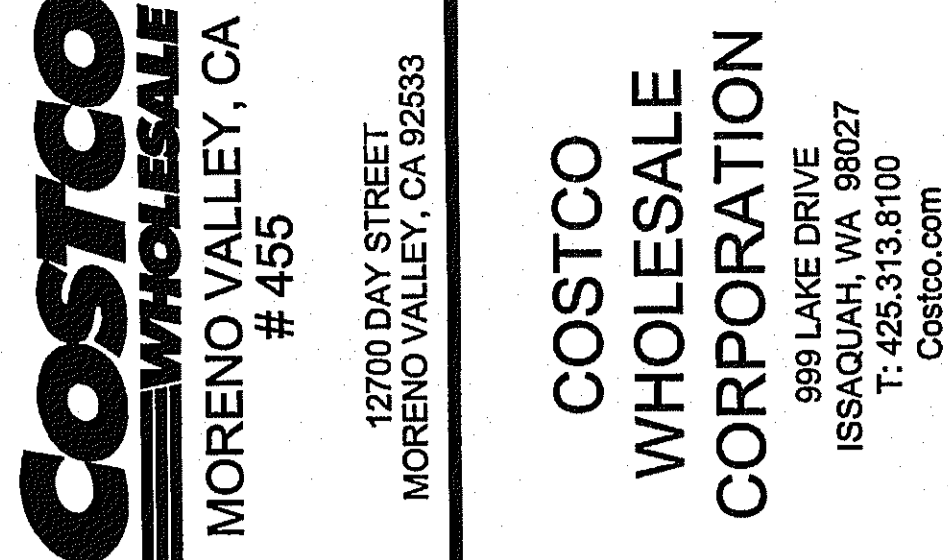

1110 112TH AVE NE | SUITE 500
BELLEVUE, WA | 98004
1.425.463.2000 | 1.425.463.2002
MulvannyG2.com

CONSTRUCTION SET

WEISER IRON
APR 8 2007
RECEIVED

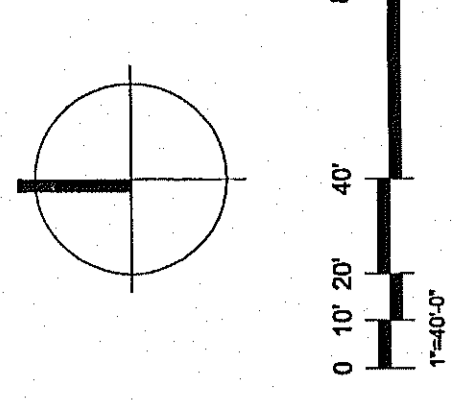

MITCHELL C. SMITH, ARCHITECT

DATE	DESCRIPTION
09-22-06	START-UP SET
11-04-06	PERMIT SET
11-21-06	ISSUED SET
12-22-06	HEALTH DEPT COMMENTS
1-15-07	PLAN CHECK COMMENTS
3-22-07	OWNER CHANGES
3-27-07	ISSUE FOR CONSTRUCTION

04.05.07
P.W. DAVIS PREPARED
DRAWN BY
MARCH 27, 2007

SITE PLAN

SD1.01

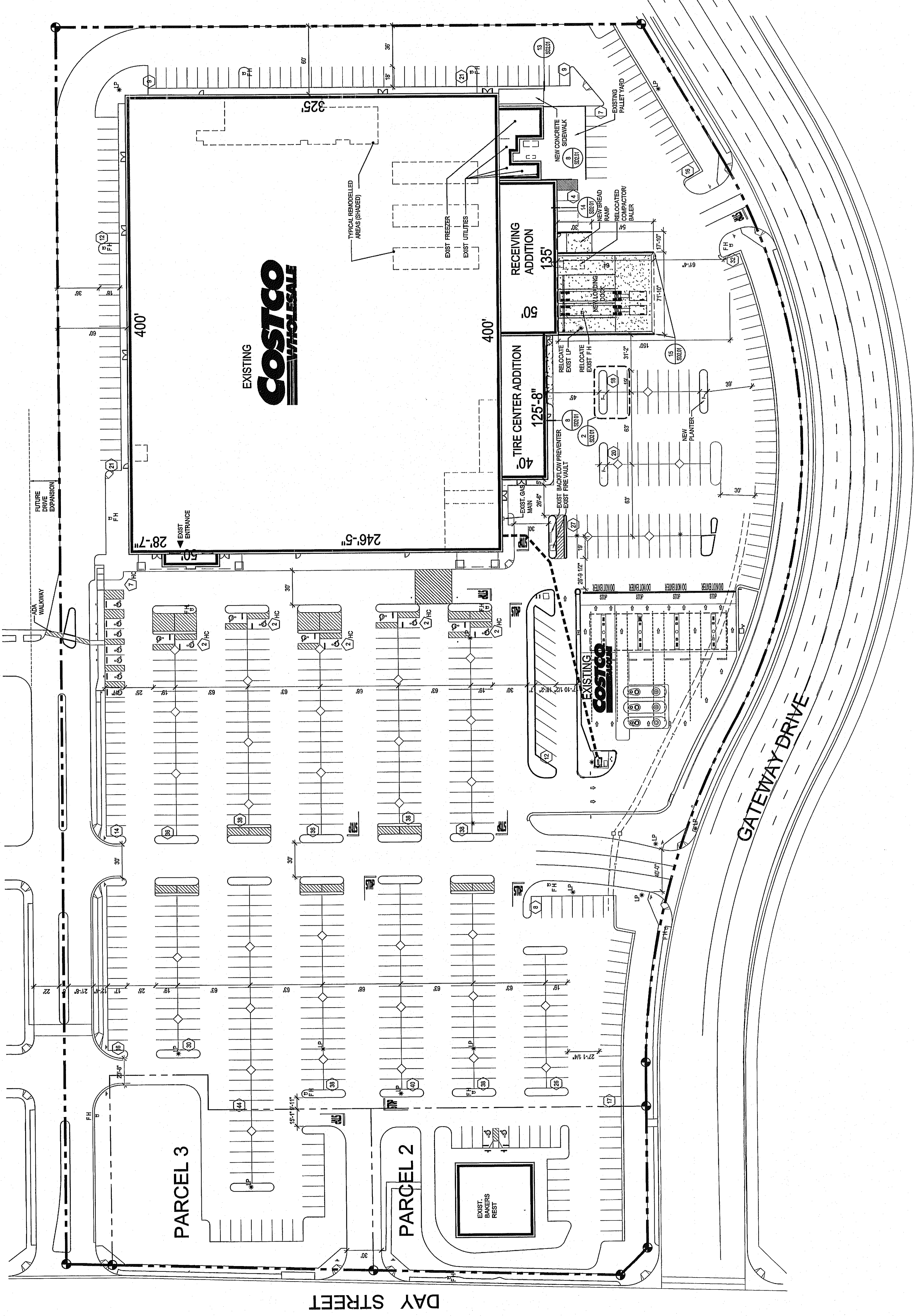

CURBS SHALL BE PAINTED "FIRE RED" ON TOP AND LEADING EDGE. TOP SIDE OF CURB SHALL HAVE WHITE STENCILED LETTERS STATING "NO PARKING FIRE LANE" IN 4" MINIMUM LETTERS SPACED NO LESS THAN 20' OR NO MORE THAN 35' ON CENTER.

SITE PLAN
SCALE: 1" = 40'-0"

KEY NOTE

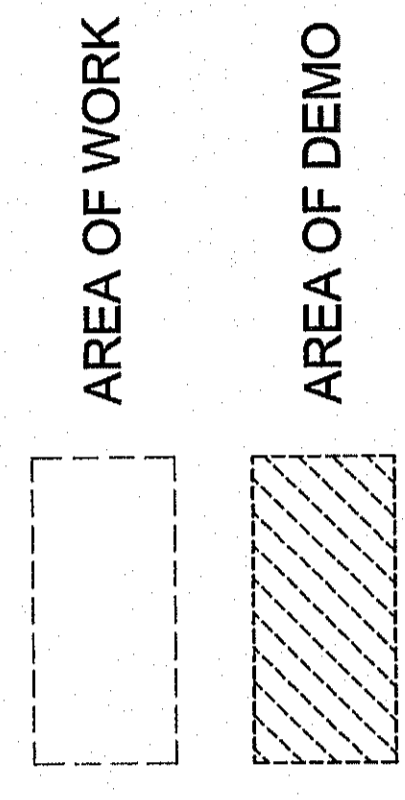

VICINITY MAP

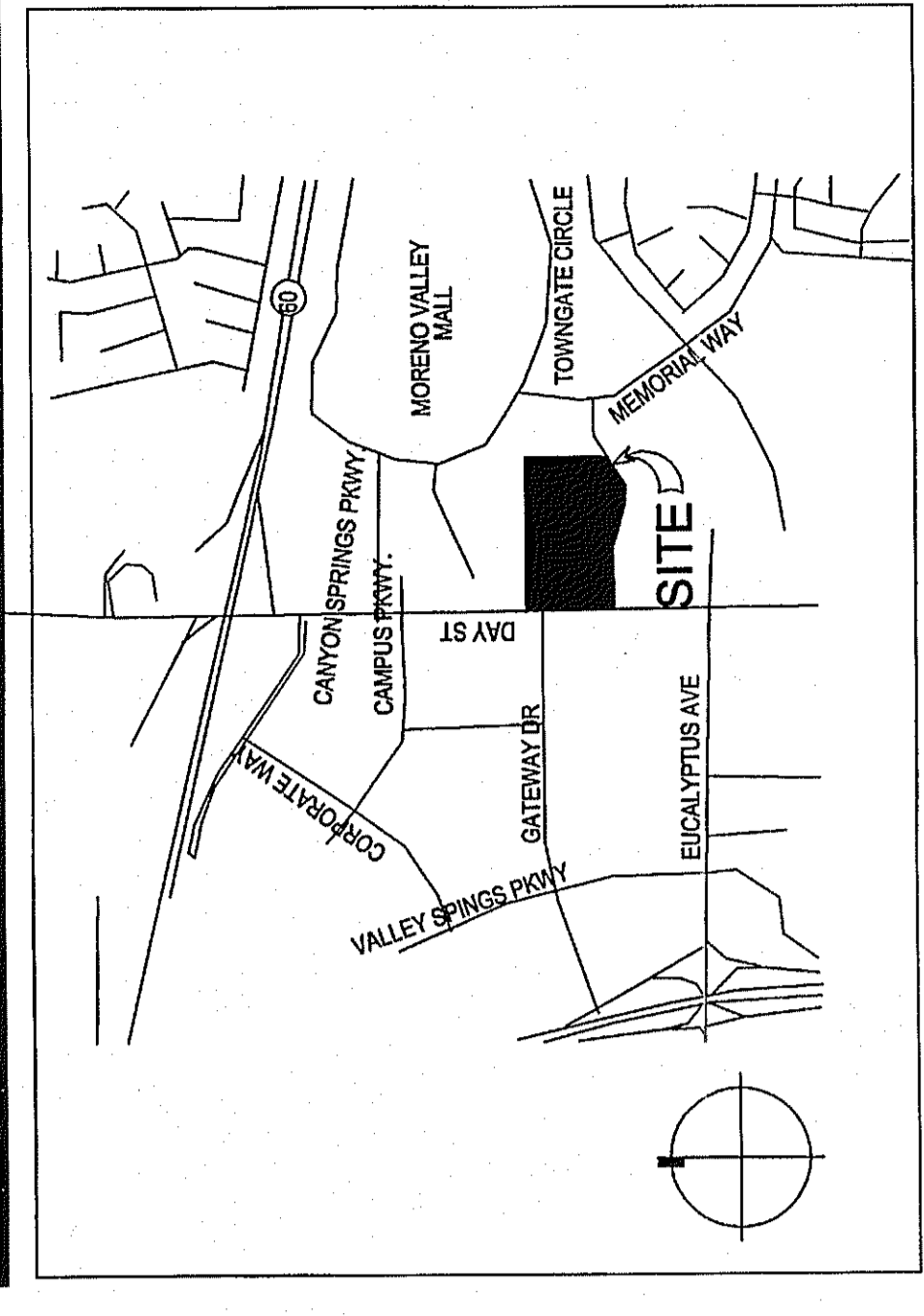

NOTES:
EXISTING CONDITIONS TO BE FIELD VERIFIED.