

SUPPLY ROOM ELEVATIONS

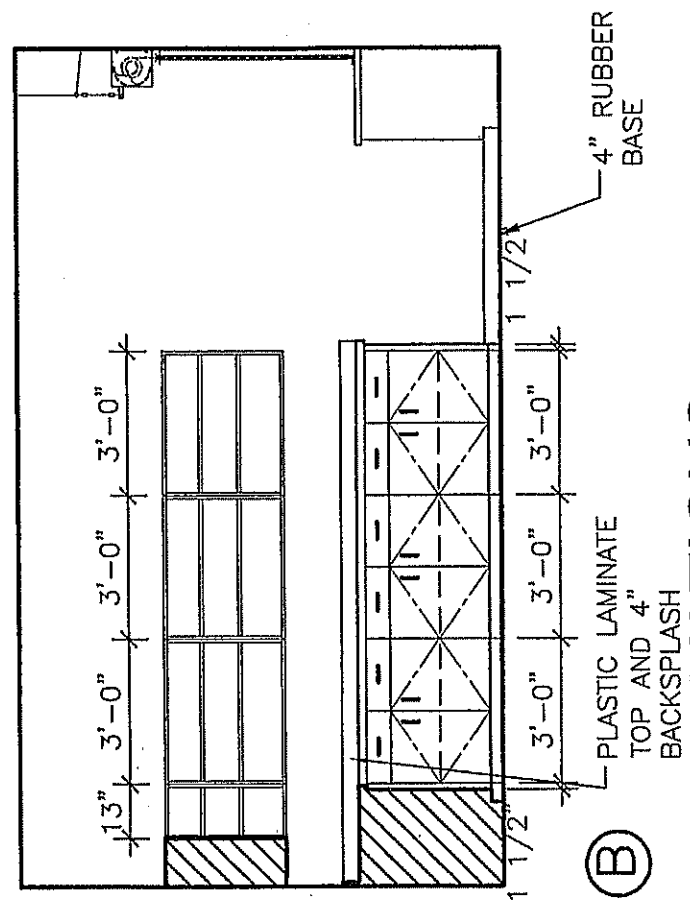
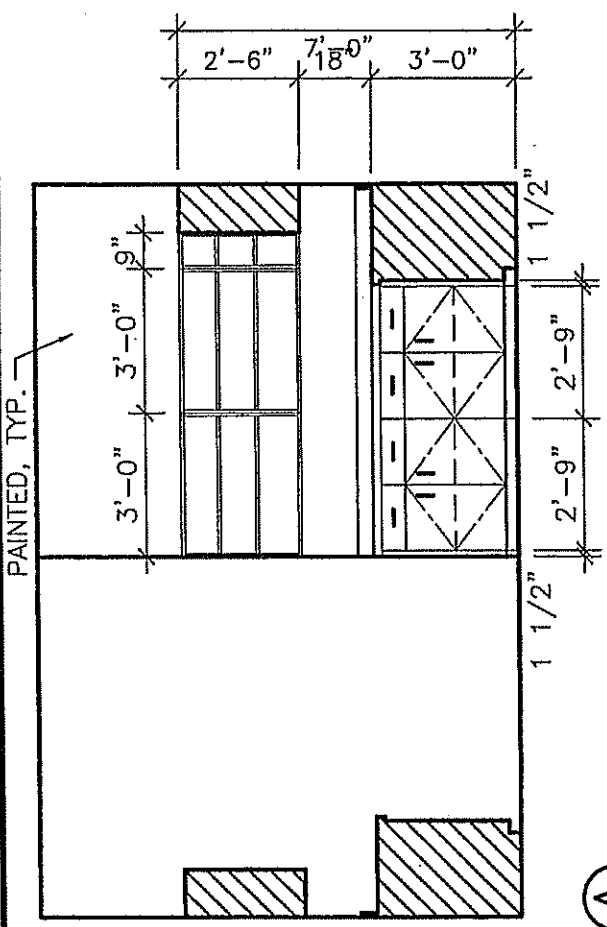

WEISER IRON
 APR 18 2007
 RECEIVED

<p>PROJECT: CALVARY CHAPEL OF THE HIGH DESERT</p>	<p>DESCRIPTION: INTERIOR ELEVATIONS</p>	
<p>Brian R. Bloom-Architect ARCHITECTURE AND PLANNING 350 S. Milliken Ave., Ste. G Ontario, CA 91761-7850 (909) 390-7209 FAX (909) 390-7509</p>	<p>SCALE: 1/4" = 1'-0"</p>	<p>SHEET NO. A5.3</p>
	<p>DATE: 04/12/07</p>	
	<p>JOB #: 260106</p>	